



PRESSURE SNUBBER WITH CHOKE VALVE



Pressure Snubber with Choke Valve

FEATURES:

- Adjustable pressure pulsation dampener protects pressure gauges against pressure perturbation, surges, and fluid hampers
- Isolates gauge for service or replacement

APPLICATIONS:

- Pulsation
- Heavy duty process
- Industrial

PRESSURE RANGES:

- 3,000 to 10,000 PSI

SPECIFICATIONS:

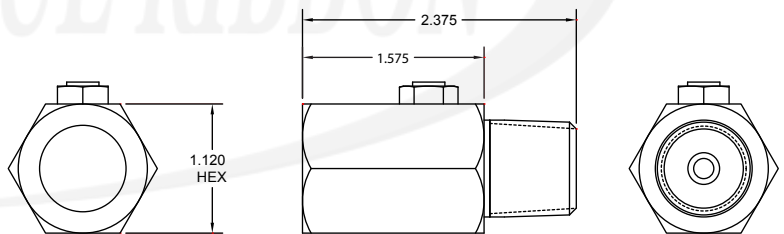

STAINLESS STEEL SNUBBER

PART #	THREAD	"B"	"C"	"D" HEX	MAXIMUM PRESSURE
MSB4	¼-½ NPT	0.51" (13 mm)	1.77" (45 mm)	0.67" (17 mm)	3,000 PSI
MSS4	¼-½ NPT	0.51" (13 mm)	1.77" (45 mm)	0.67" (17 mm)	5,000 PSI
MSB6	⅜-½ NPT	0.59" (16 mm)	2.36" (60 mm)	1.18" (30 mm)	5,000 PSI
MSS6	⅜-½ NPT	0.59" (16 mm)	2.36" (60 mm)	1.18" (30 mm)	10,000 PSI
MSB8	½-¼ NPT	0.79" (20 mm)	2.36" (60 mm)	1.18" (30 mm)	5,000 PSI
MSS8	½-¼ NPT	0.79" (20 mm)	2.36" (60 mm)	1.18" (30 mm)	10,000 PSI